



Eva Bridgeman
Downey Planning
1 Westland Square
Pearse Street
Dublin 2, D02 EP02

1st September 2021
LOC.023.2021

Re: Letter of Consent – Gerard Gannon Properties
Consent Granted

Dear Eva,

I confirm that the Property Services Section, Economic Enterprise, Tourism & Cultural Development Department of Fingal County Council consent **only** to the inclusion of that land in the charge of Fingal County Council as identified and shown coloured in green on Drawing No. 1732 PA1 100 **for the purpose of the planning application and for no other purpose.** It is the responsibility of the applicant for planning permission to ensure that the drawing supplied correctly reflect the boundaries of the land stated to be in ownership/charge of the Council.

Furthermore, it should be noted the within consent does not confer any rights to Gerard Gannon Properties in respect of the land identified and this letter shall not constitute a note or memorandum in writing for the purpose of Section 51 of the Land and Conveyancing Reform Act 2009.

In the event that planning permission is granted no works should commence without prior written agreement from the Property Services Section of Fingal County Council.

This letter is issuing on the basis of the undertaking given by the applicant of prior discussions with Council officials in relation to the land.

Yours sincerely,

Emer O'Gorman
Director of Services
Economic, Enterprise, Tourism & Cultural Development Department

- © This drawing is copyright.
- 1 Do not scale this drawing.
- 2 Errors and omissions to be immediately notified to Architect.
- 3 All dimensions to be checked on site.
- 4 To be read with relevant Engineers drawings.



© Ordnance Survey Ireland and Government of Ireland
Licence No. AR008821

Map Series | Map Sheets
1:1,000 | 2925-18
1:1,000 | 2925-19
1:2,500 | 2925-D
1:2,500 | 2925-C

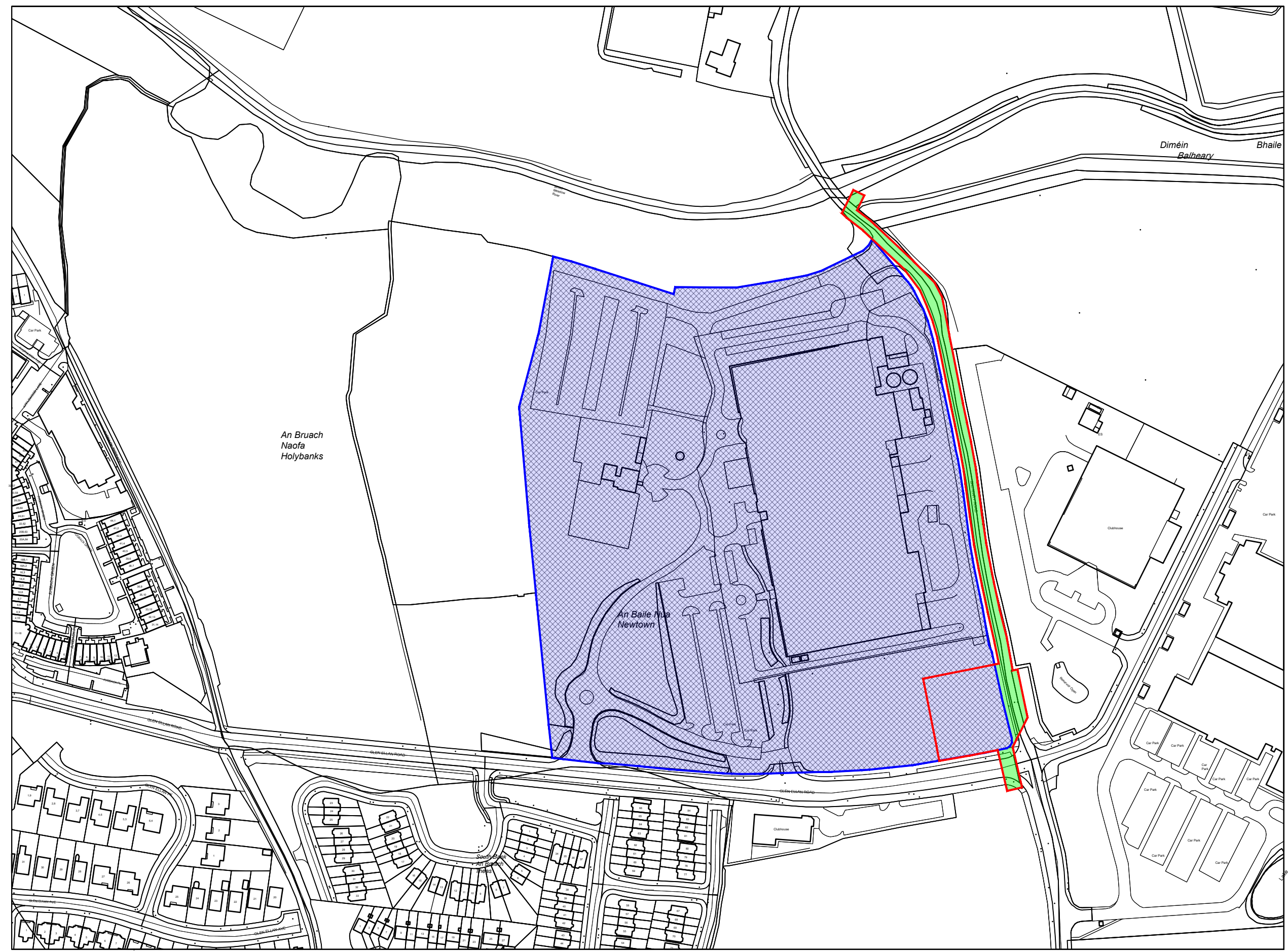

- Denotes Gannon Properties Lands.
- Denotes Planning Application Red Line.
- Denotes Fingal County Council Lands included in this application.

revisions	date	ins
description		
Fingal County Council Lands		

job	scale	drawing no.
Storage Tank and Overflow at Holybanks, Swords, Co. Dublin	1:2500 A3	1735 PA1 100
	date	revn.
	Aug'21	
	drawn	
	KL	
	checked	
	KL	

client
Gannon Properties

issue
Information

CONROY CROWE KELLY ARCHITECTS
65 MERRION SQUARE
Dublin 2
PHONE 66139901 FAX 6765715
E-MAIL info@cck.ie